



## T-rex 550E T-rex 550E 3G Part Finder



Use the bookmark bar on the left to speed navigation.

For best results, save this file to your hard drive in a location that is easy to find, such as your desktop. When you want to use it, open it with Acrobat Reader. Just click on a part and your default browser will open with that part in the window.

For more information and tips on using the part finder, visit the Part Finder page. There's a link at the bottom of each store page.



Firefox users:

To keep from opening multiple tabs do the following:  
In the address bar type about:config then press enter.  
Click the "Void the Warranty" button.  
In the filter box type window  
The second item down should be  
browser.link.open\_newwindow  
Double click on that line and change the value to 1  
Close Firefox.

Now when you open the part finder with Adobe Reader, only the active tab will be populated with the part finder item.

I've been using it this way for a while and it works great.

Firefox is a wonderful browser once you get used to it. I highly recommend downloading it and then use it for an hour or two before you decide. You can get it here.

# Flybarless

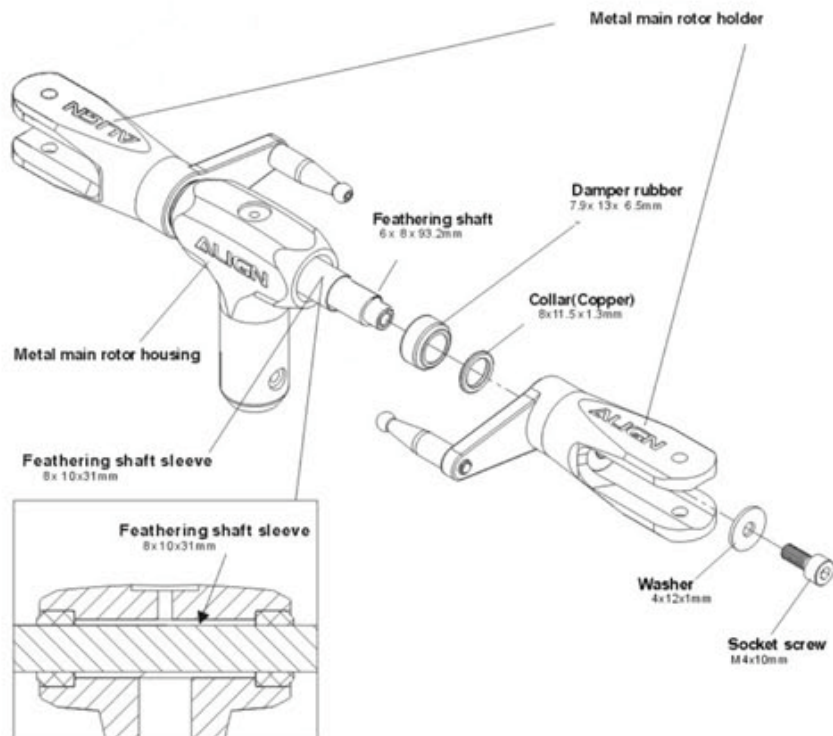
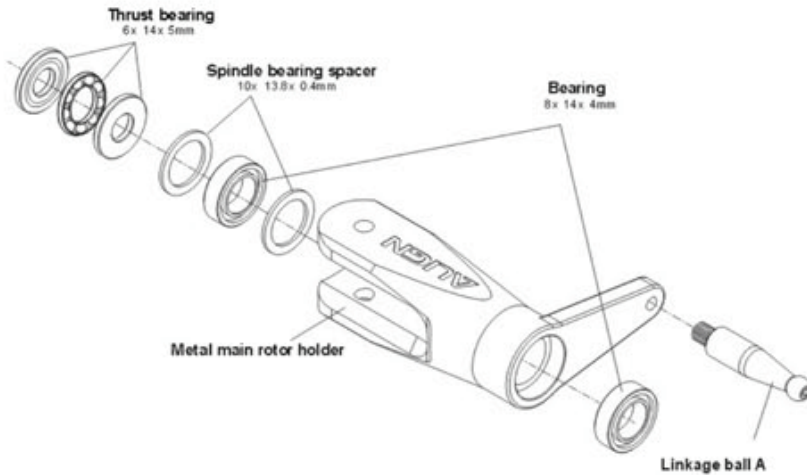

# Flybar

Notice the orientation of the blade grips vs. the flybarless head

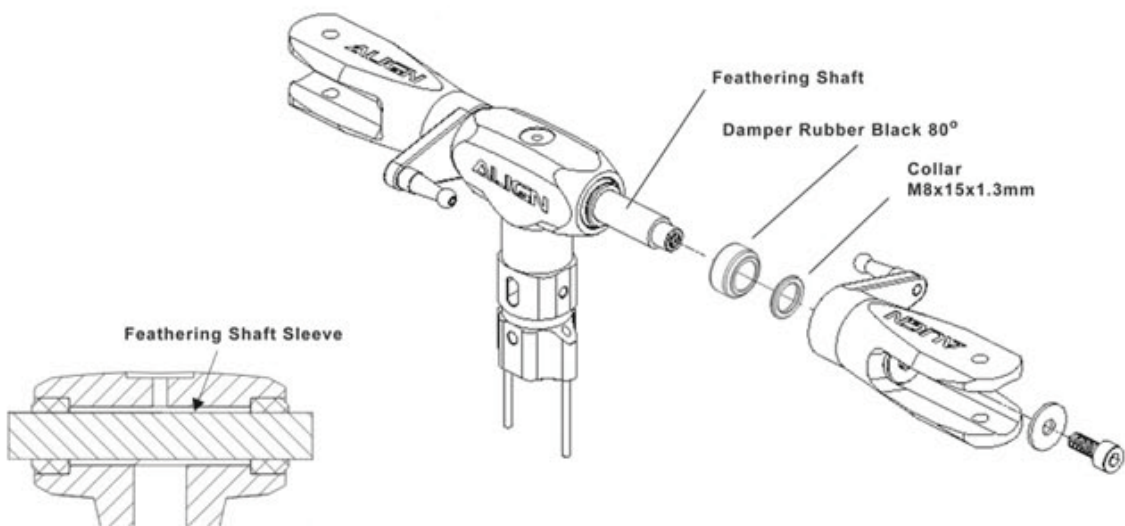
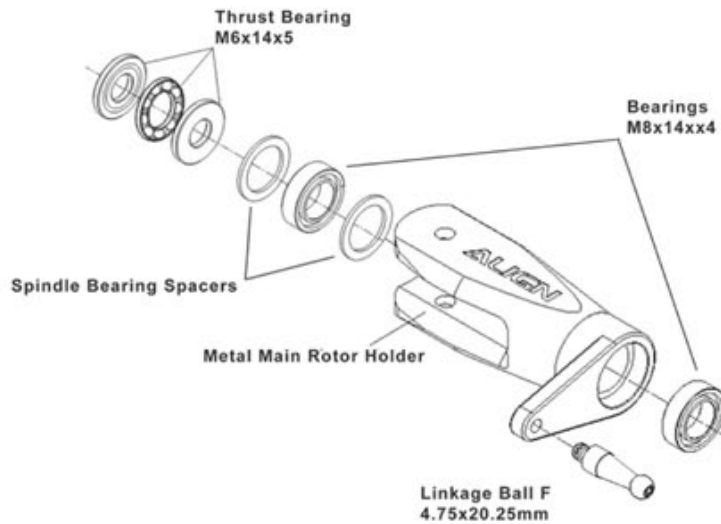

# Flybarless

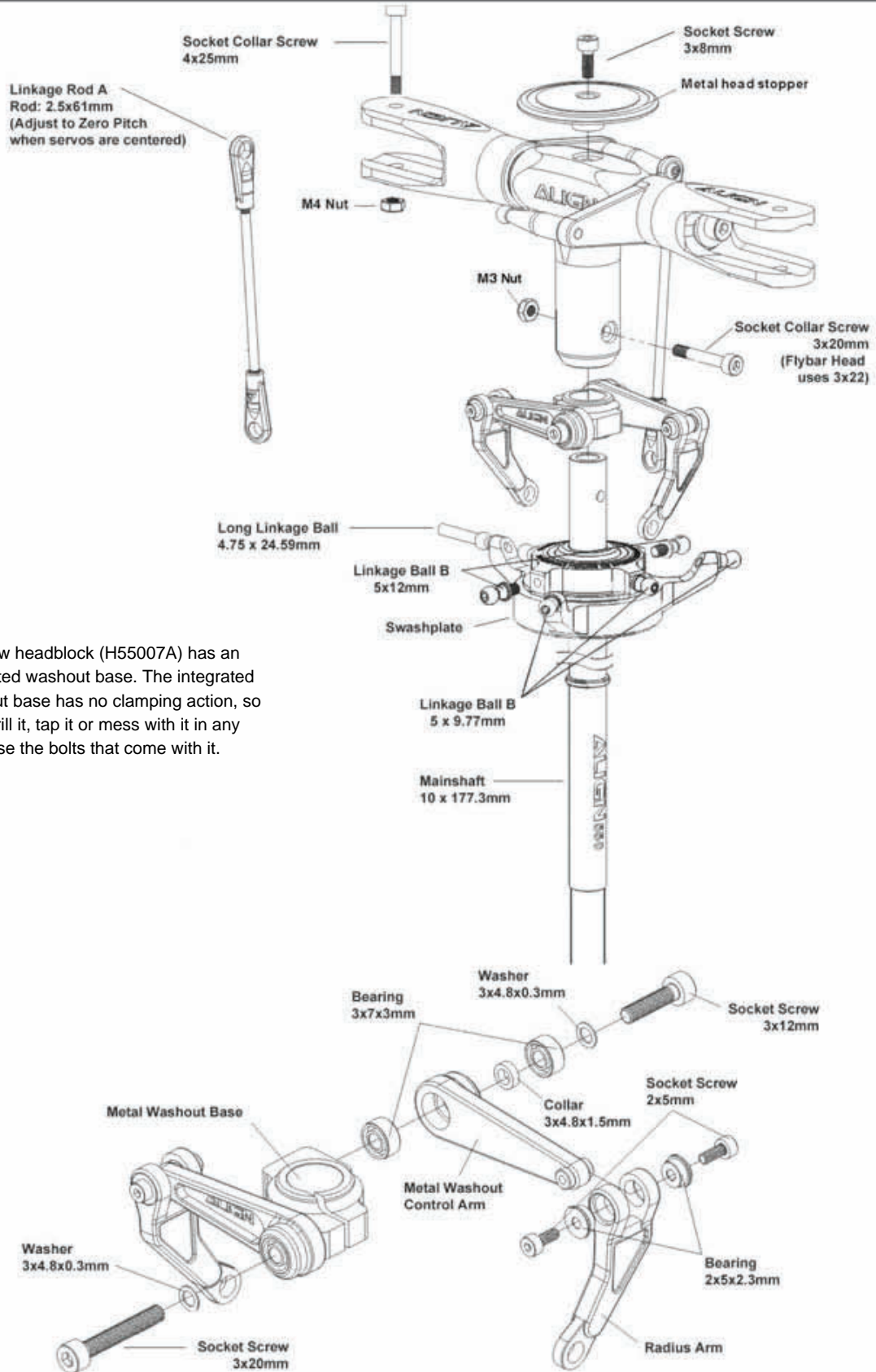

The new headblock (H55007A) has an integrated washout base. The integrated washout base has no clamping action, so don't drill it, tap it or mess with it in any way. Use the bolts that come with it.

# Flybar

## Metal Flybar Seesaw Holder

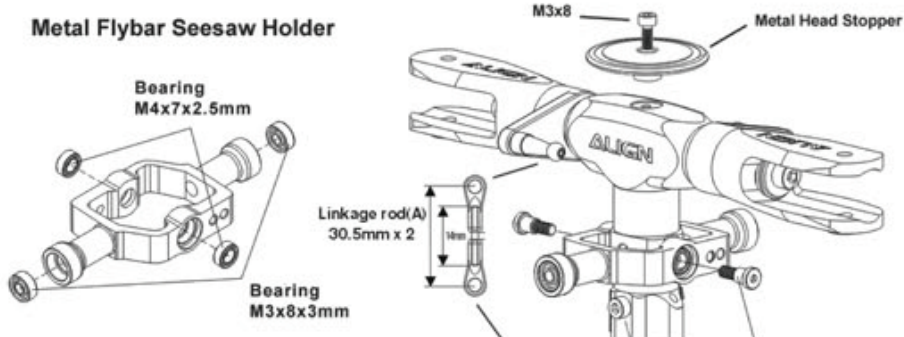

[Click here for Blade Bolts](#)

[Click here for all 550 LINKAGE rods and links for the model with a flybar. Tail rotor rods are located on the Tail Boom page.](#)

## Seesaw (SF) Mixing Arms x2

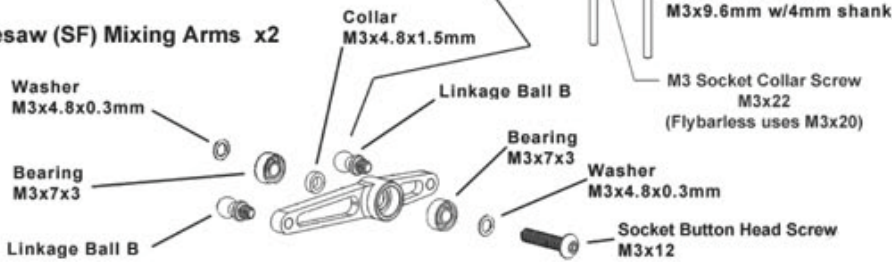

## Metal SF Mixing Arm

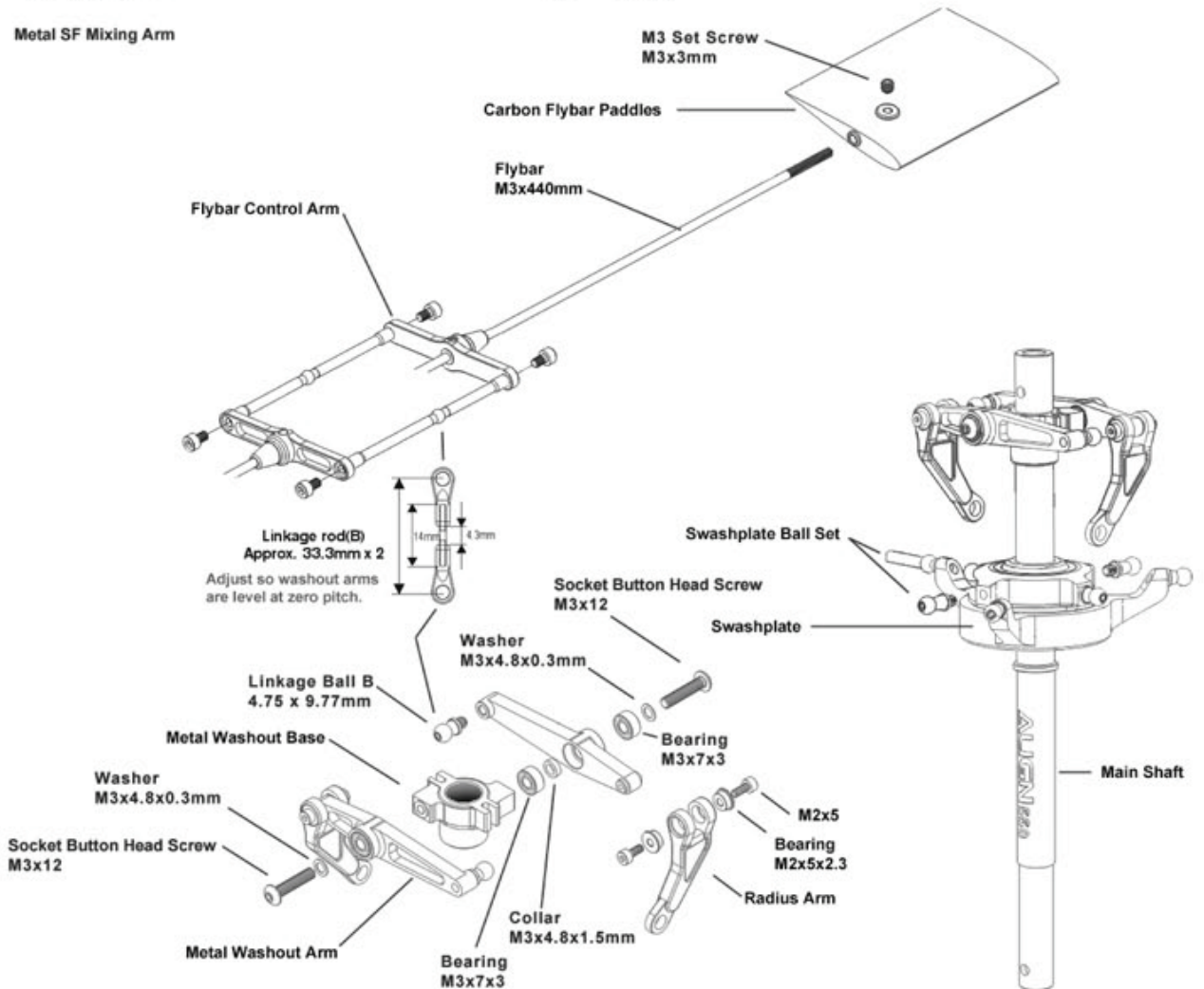

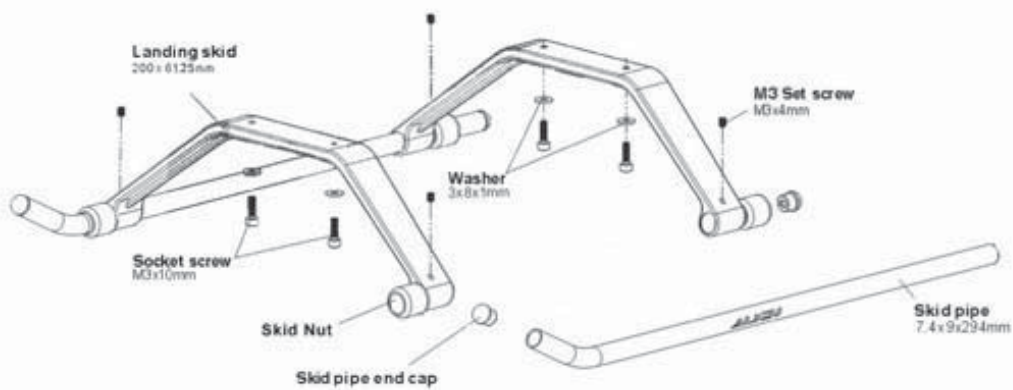
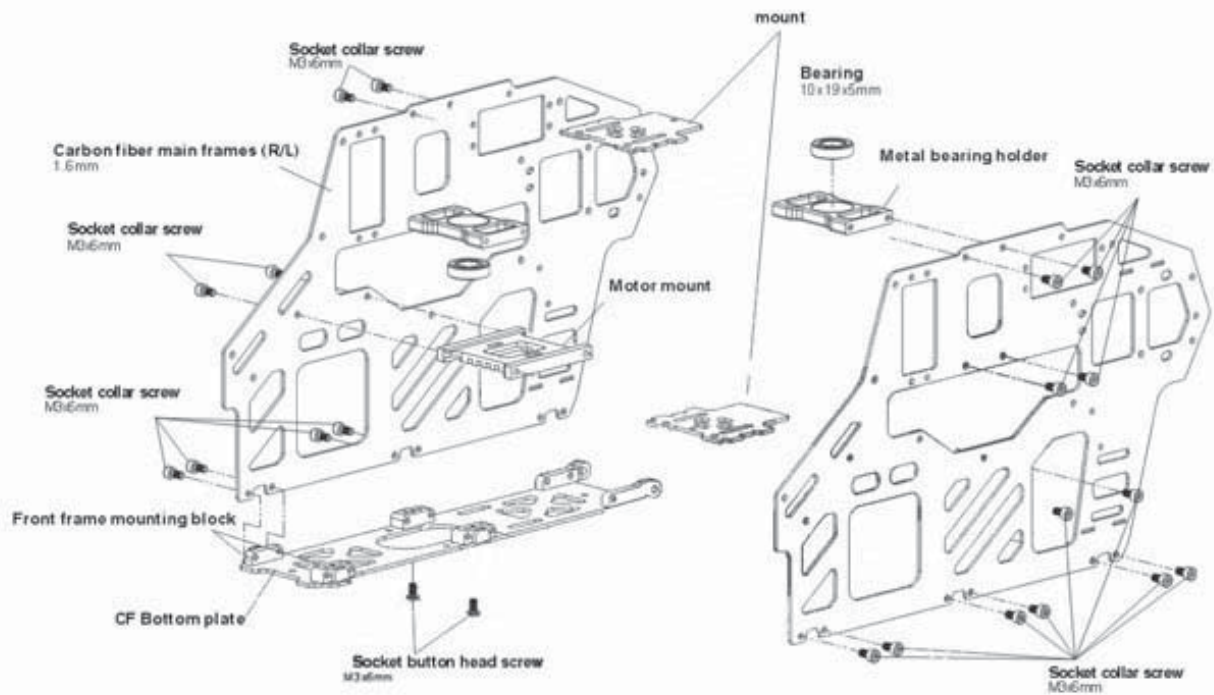

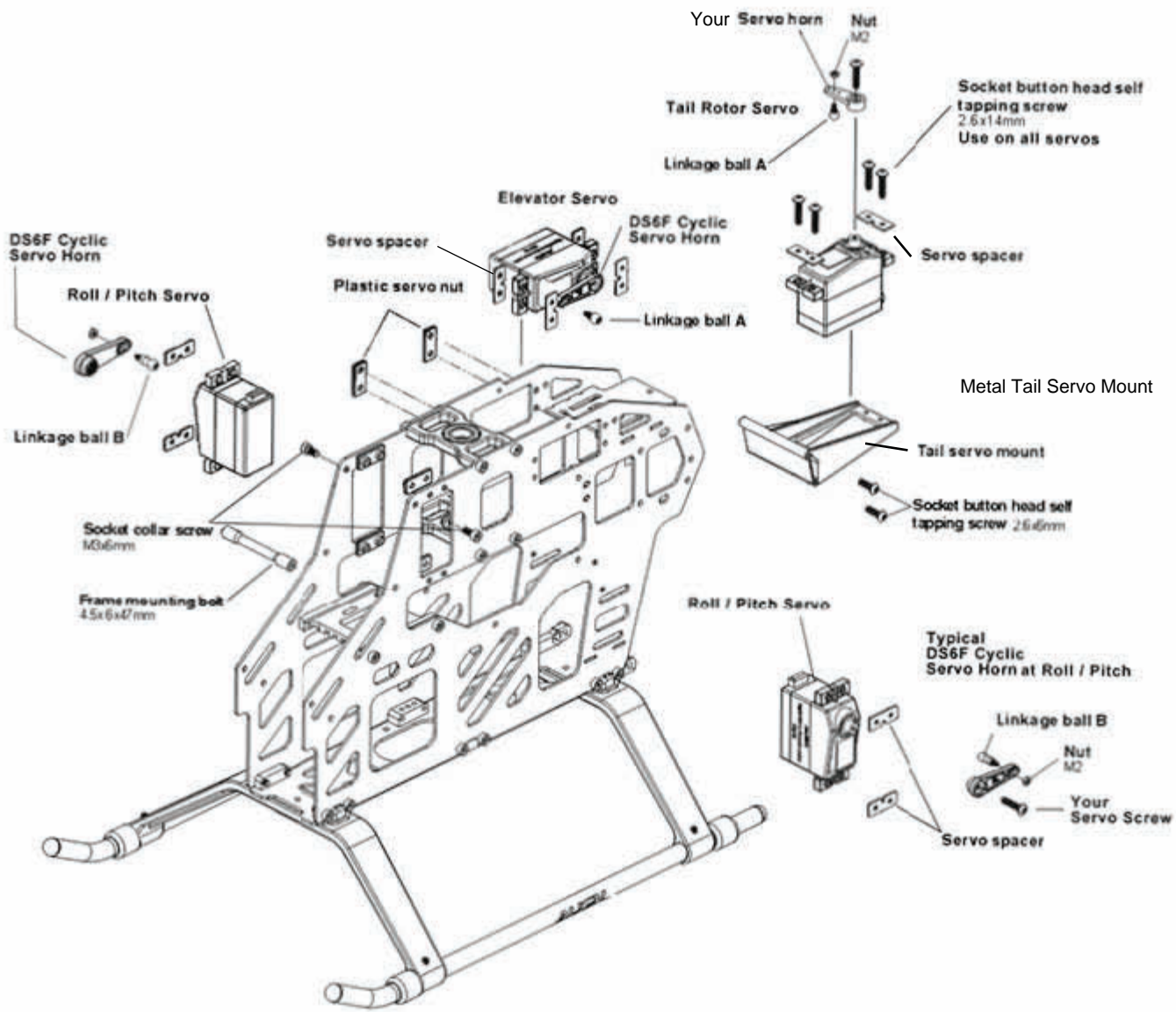

Flybar and Flybarless are the same from here down with one exception. The flybarless models have 2 longer balls on the inside ring of the swashplate. The longer balls connect to the pitch arm via Linkage Rod D.

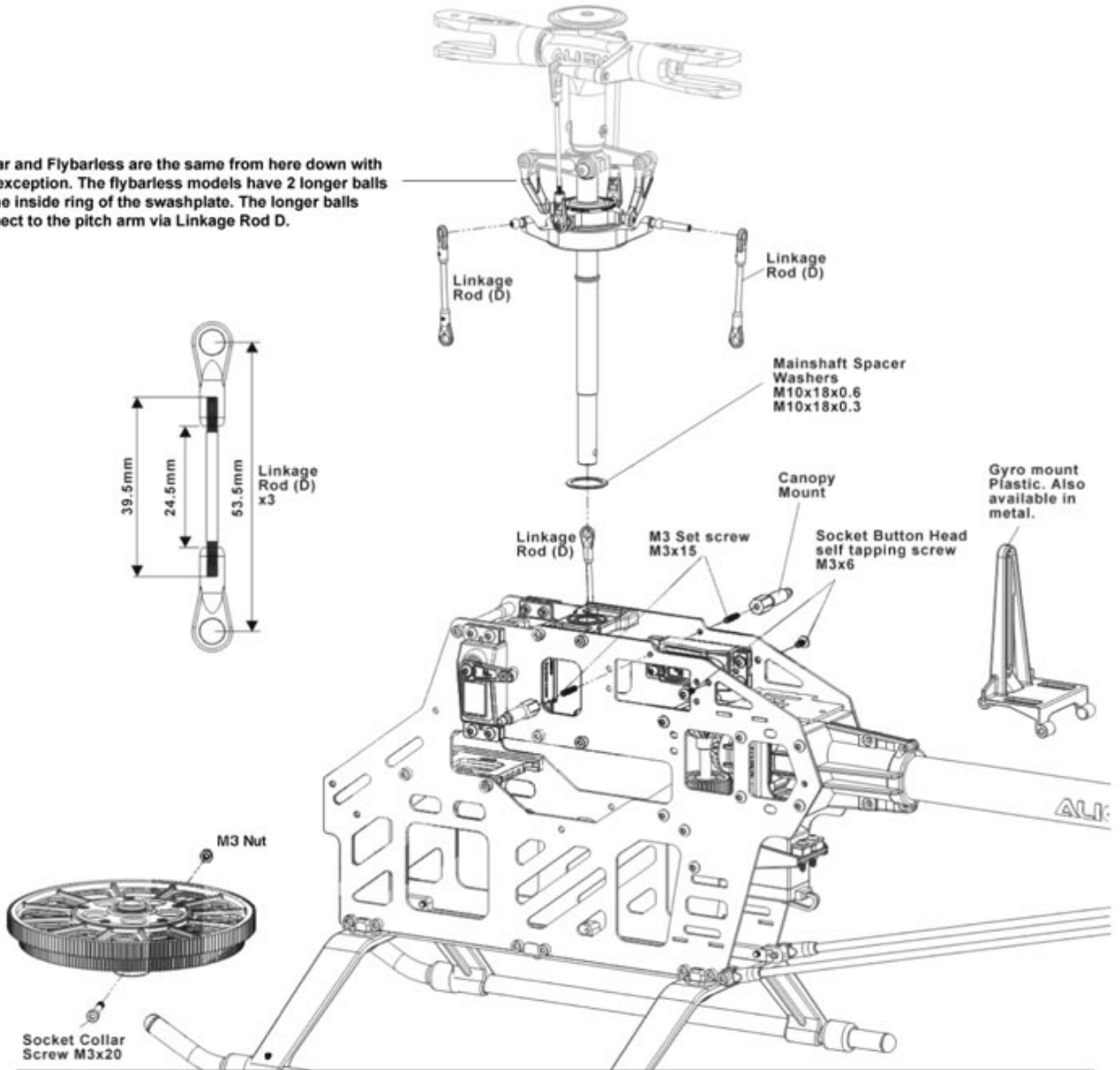

A 188T Spiral Cut Main Gear is also available. An 18T Pinion is available to use with it. [Click here for details.](#)

Autorotation Tail Drive Gear 180T

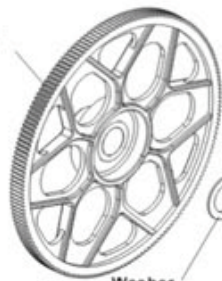

Main Drive Gear 170T



One way Bearing M12x18x16

Hex Socket Self Tapping Screw M3x7

One way Bearing Shaft

Washer M11.5x18x0.8

Main Gear Case

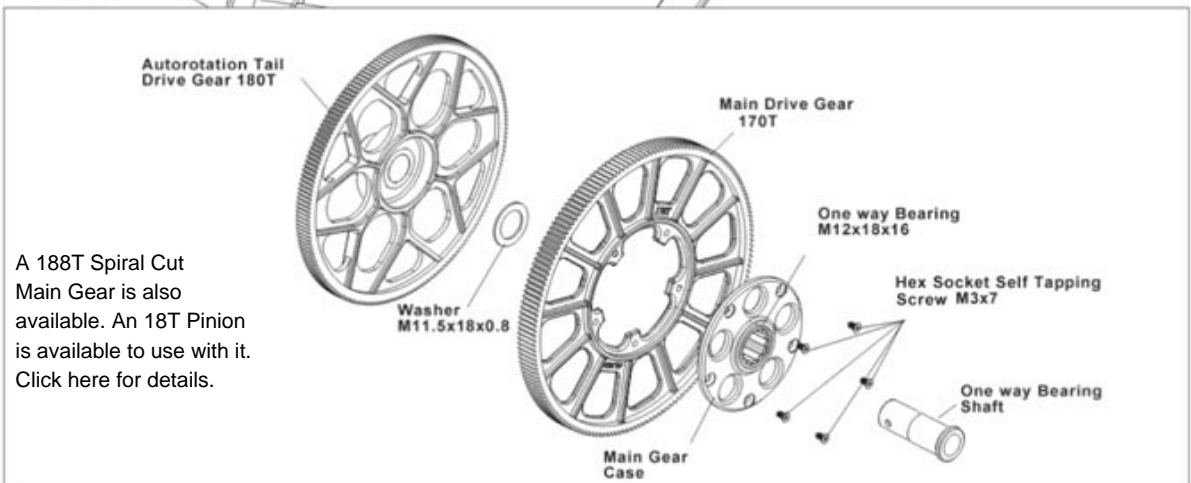

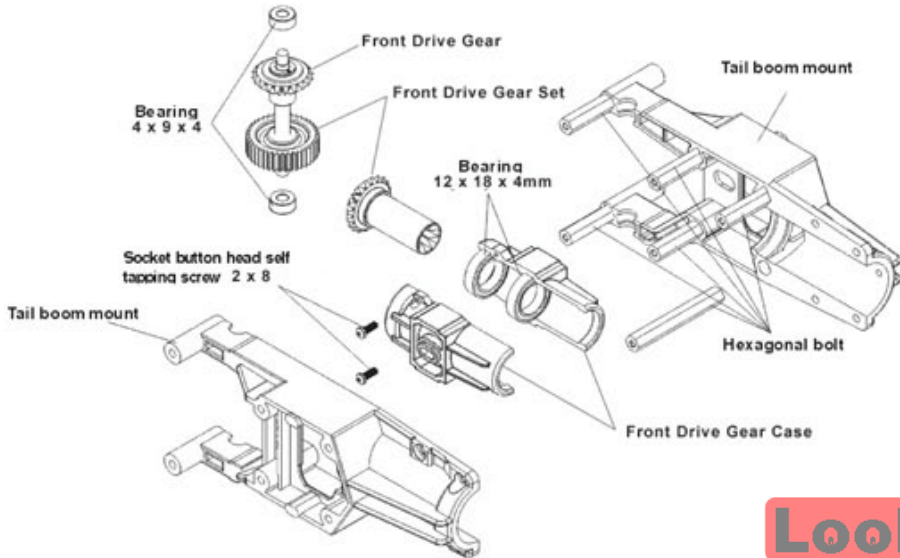

**Look**

It is possible to convert the 550 to a belt drive. You would need the following:  
 H55065 Belt  
 H60043 Tail Case  
 H60079 Tail Output Shaft  
 H60078 Front Tail Drive

**Look**

[Click here for the complete Metal Tail Unit](#)

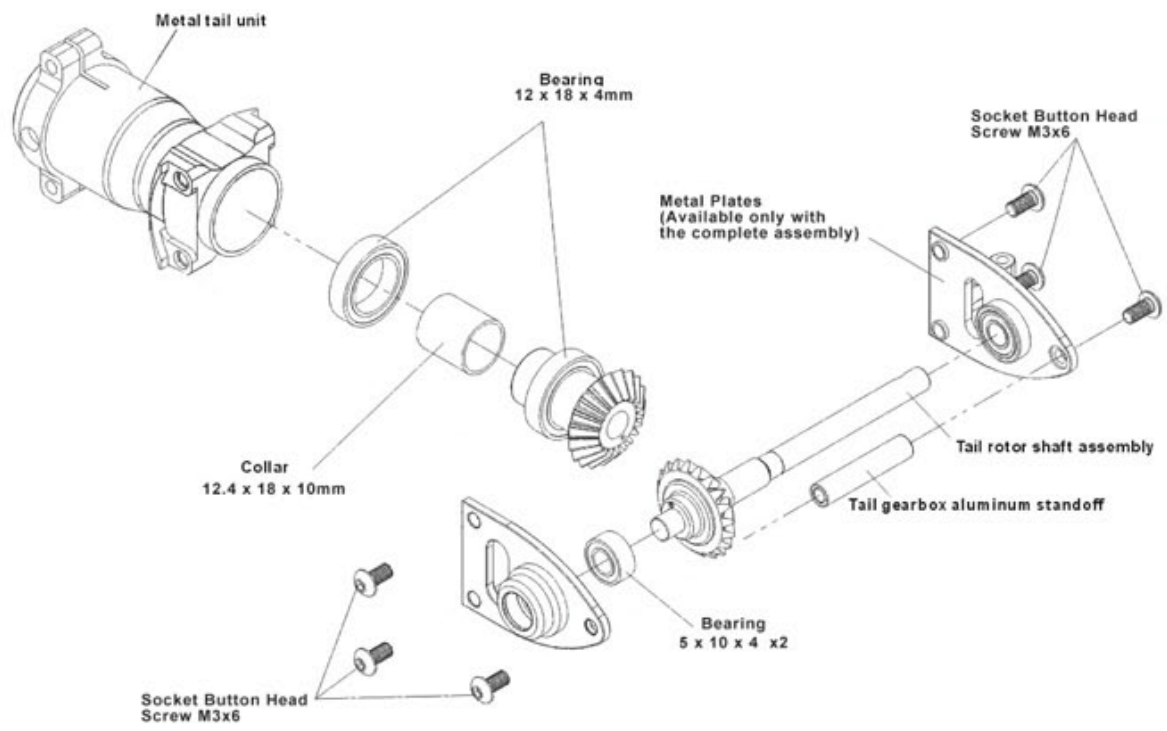

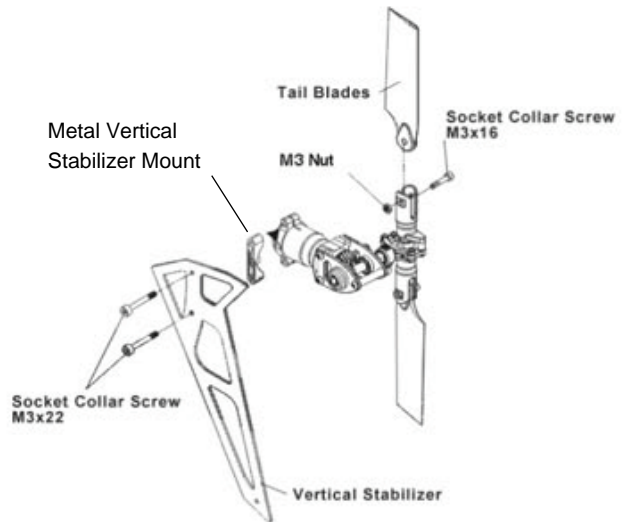
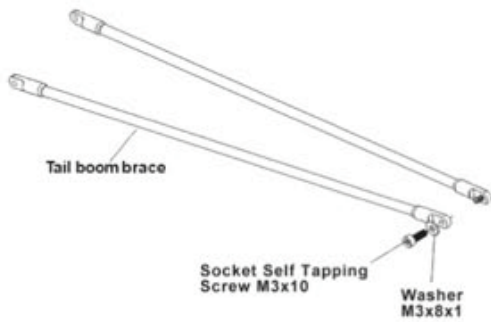
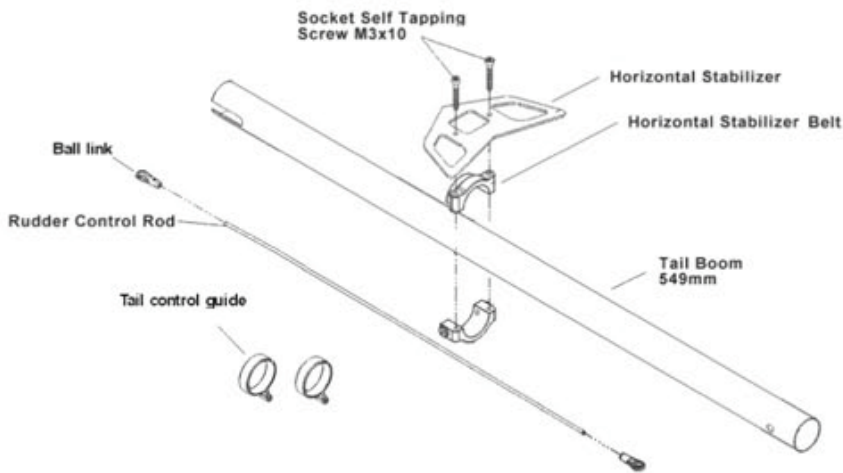
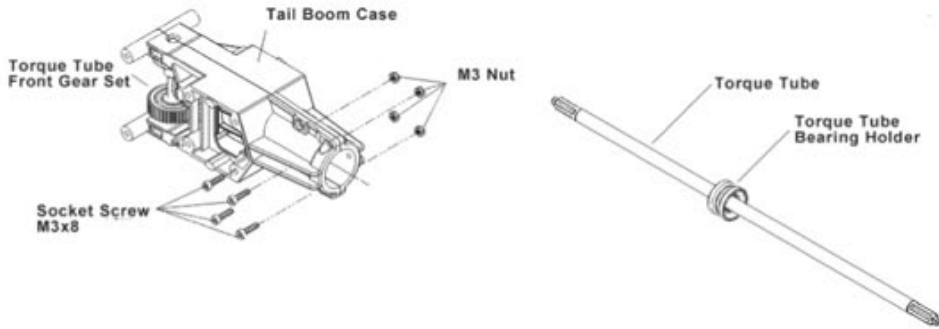

# Look

It is a good idea to check the ball on your tail rotor bellcrank before each flight. If there is any up and down play, replace the ball. The plastic links last much longer than the balls. Be sure to get the correct ball for your particular bellcrank. You can also use other balls as long as they have a 2mm thread and are long enough to put a hex nut on the part that goes through.

# Look

When installing thrust bearings, be sure to check to make sure the race with the smaller ID is farthest from the hub.

Be very careful to clean the hub with Acetone before installing the bolt. Do not use too much Loctite. If you get Loctite in the thrust bearing you will have a real problem with the tail. Using a pipette helps.

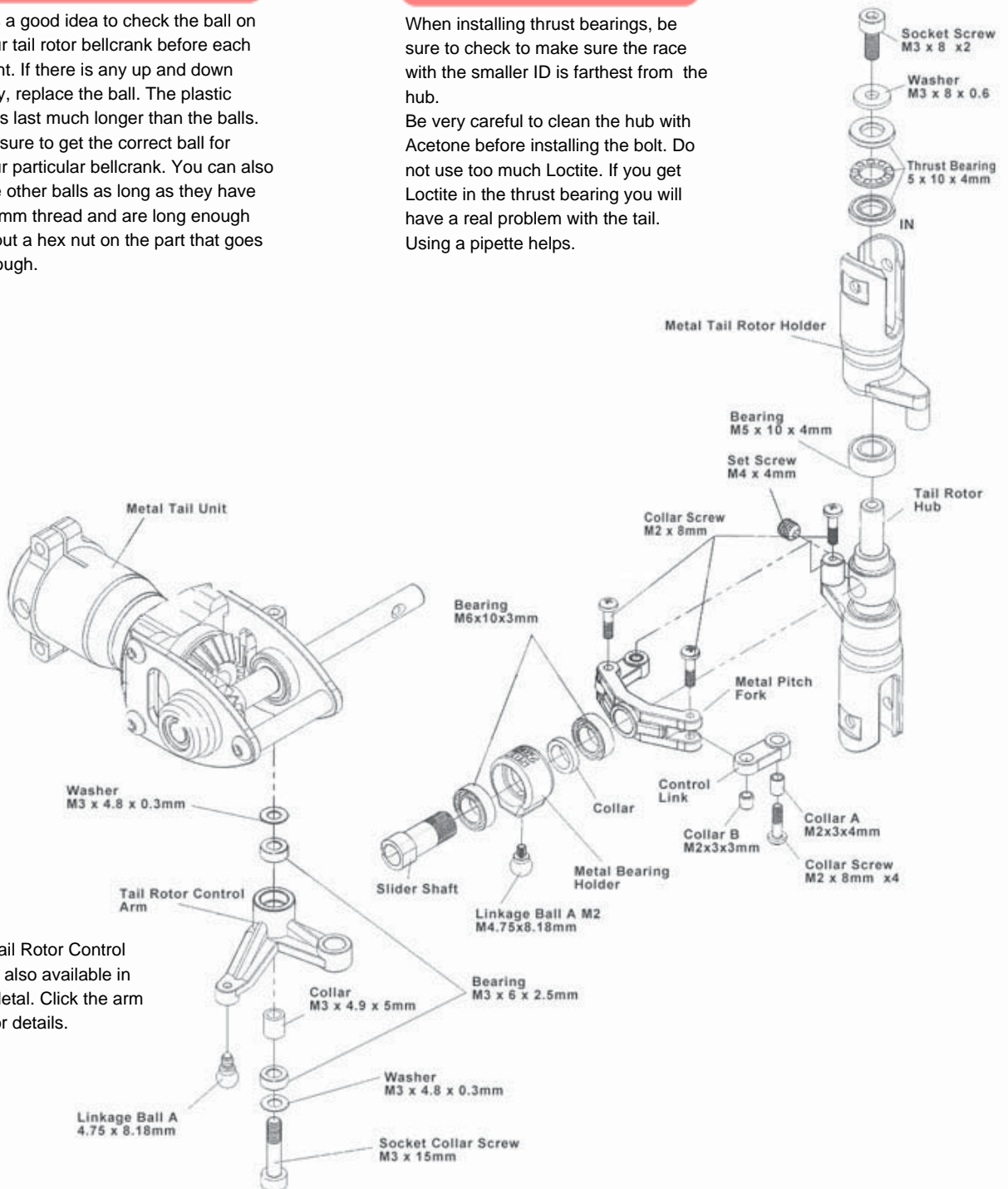

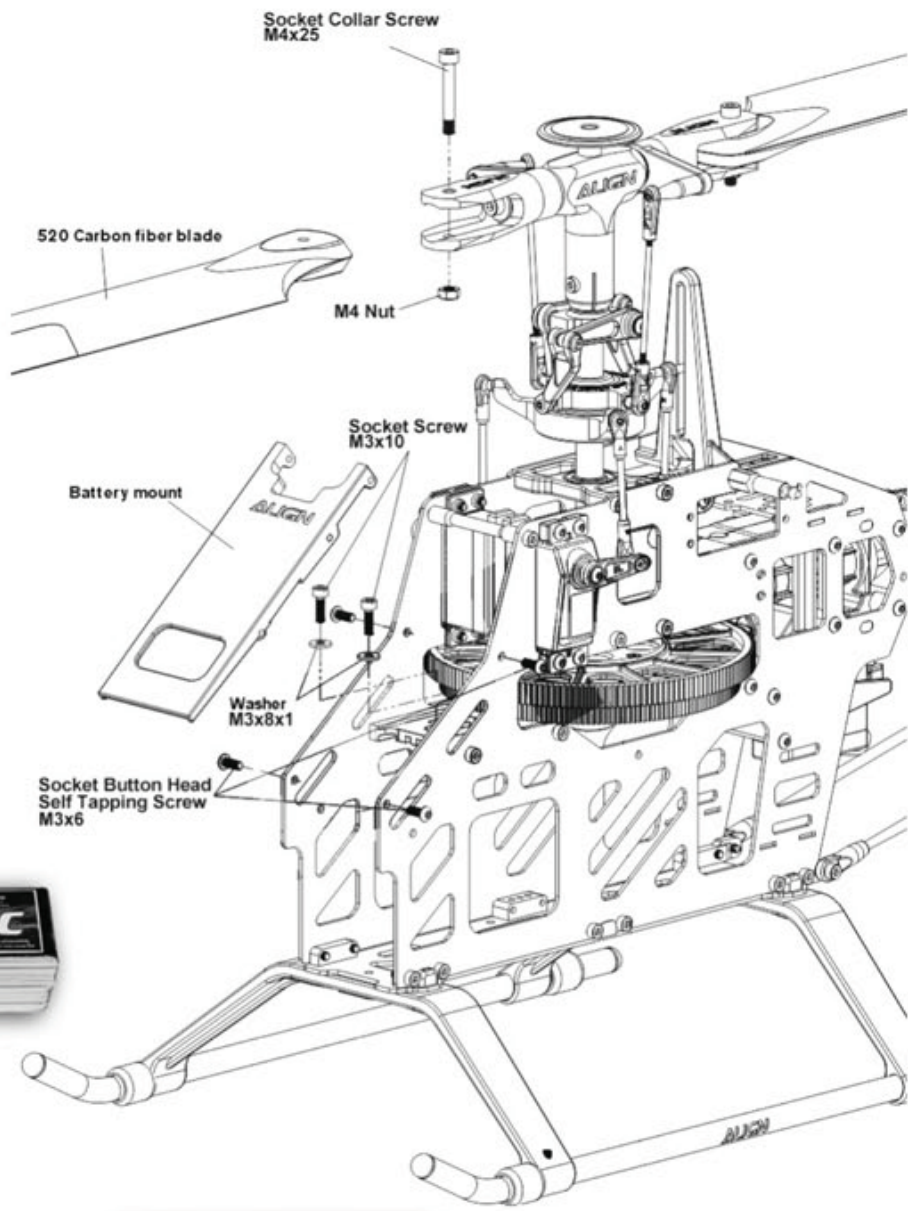

6S Lipo Batteries



Chargers



Receivers



Speed Controllers

Standard Equipment is RCE-B70G